

Multi Hazard Multi-jurisdiction Mitigation Project Worksheet

County: <i>Nelson</i>		
Jurisdiction: <i>Nelson County Water Resource District</i>		
Contact Name: <i>Ben Varnson</i>	Contact Number: <i>Cell 701 739 3900 701 249 2682</i>	Contact Email: <i>ncaurd@polarcomm.com cayee@polarcomm.com</i>
Project Location: <i>N 1/2 sec 19 151 N 61W Leventwp.</i> City: <i>Nelson County Twp., Nelson County Park and Road in West Nelson County</i>		
Street Address: or Latitude: <i>MAP SITE #1</i> Longitude:		

Priority Ranking	High <input checked="" type="checkbox"/>	Medium <input type="checkbox"/>	Low <input type="checkbox"/>	Undetermined <input type="checkbox"/>
Project Feasibility				
Socially Acceptable	Yes <input checked="" type="checkbox"/>	No <input type="checkbox"/>		
Technically Feasible	Yes <input checked="" type="checkbox"/>	No <input type="checkbox"/>		
Administratively Possible	Yes <input checked="" type="checkbox"/>	No <input type="checkbox"/>		
Politically Acceptable	Yes <input checked="" type="checkbox"/>	No <input type="checkbox"/>		
Legal	Yes <input checked="" type="checkbox"/>	No <input type="checkbox"/>		
Economically Feasible	Yes <input checked="" type="checkbox"/>	No <input type="checkbox"/>		
Environmentally Acceptable	Yes <input checked="" type="checkbox"/>	No <input type="checkbox"/>		

Recommended Mitigation Measure and Scope of Work: *Channelize natural coulee and remove sediment to protect the population of Nelson County and lower the Devils Lake Basin*

How would Project Reduce Hazard: *Low water levels in the Stump Lake and Devils Lake System.*

Identification of Protected Species, Environmental, Historical, and/or Cultural Impact: *Protection from further damage to trees, erosion to banks around lake systems, roads, infrastructure and the people of Spirit Lake Nation, Devils Lake, Minnawaukan and to the citizens of North Dakota. Also protects Camp Greffer*

Estimated Timeline: *2010-2011*

Estimated Cost: *\$2 million*

Engineering Study Completed:	Yes <input checked="" type="checkbox"/>	No <input type="checkbox"/>
Cost/Benefit Completed:	Yes <input checked="" type="checkbox"/>	No <input type="checkbox"/> <i>not formal</i>

Project Maintenance:
What is the cost to the State and region if not done.

Multi Hazard Multi-jurisdiction Mitigation Project Worksheet

County: <u>Nelson</u> Jurisdiction: <u>Nelson County Water Resource District</u>		
Contact Name: <u>Ben Varnson</u>	Contact Number: Cell <u>701 739-3900</u> <u>701 247-2682</u>	Contact Email: <u>ncwrd@polarcomm.com</u> <u>cayee@polarcomm.com</u>
Project Location: <u>W 1/2 22 153-60</u> City: <u>LaKote</u> <u>LaKote Township</u> West side and north of city		
Street Address: or Latitude: <u>MAP SITE #2</u> Longitude: _____		

Priority Ranking	High <input checked="" type="checkbox"/>	Medium <input type="checkbox"/>	Low <input type="checkbox"/>	Undetermined <input type="checkbox"/>
Project Feasibility				
Socially Acceptable	Yes <input checked="" type="checkbox"/>	No <input type="checkbox"/>		
Technically Feasible	Yes <input checked="" type="checkbox"/>	No <input type="checkbox"/>		
Administratively Possible	Yes <input checked="" type="checkbox"/>	No <input type="checkbox"/>		
Politically Acceptable	Yes <input checked="" type="checkbox"/>	No <input type="checkbox"/>		
Legal	Yes <input checked="" type="checkbox"/>	No <input type="checkbox"/>		
Economically Feasible	Yes <input checked="" type="checkbox"/>	No <input type="checkbox"/>		
Environmentally Acceptable	Yes <input checked="" type="checkbox"/>	No <input type="checkbox"/>		

Recommended Mitigation Measure and Scope of Work:
Update tile line used for emergency with a new electric pump station including electricity line and components. Project would be operated to dewater landfill and farm yards and protect railroad bed and 2 township roads.

How would Project Reduce Hazard:
Place safety to roadways. allow use of roadways to landfill and protect people and provide travel for emergency vehicles

Identification of Protected Species, Environmental, Historical, and/or Cultural Impact:
All of these features are negotiated with and sheet water levels are necessary to protect the human species

Estimated Timeline:
2009-2010

Estimated Cost: \$79,000

Engineering Study Completed:	Yes <input checked="" type="checkbox"/>	No <input type="checkbox"/>
Cost/Benefit Completed:	Yes <input checked="" type="checkbox"/>	No <input type="checkbox"/>

Project Maintenance: Occasional maintenance is always expected to any project. Pumping through tile is less sediment concerns

Multi Hazard Multi-jurisdiction Mitigation Project Worksheet

County: <u>Nelson</u>		
Jurisdiction: <u>Nelson County Water Resource District</u>		
Contact Name: <u>Ben Varnson</u>	Contact Number: <u>Cell 701 739 3900</u> <u>701 247-2682</u>	Contact Email: <u>newrd@polarcomm.com</u> <u>cayee@polarcomm.com</u>
Project Location: <u>Sec. 32-33-153-58</u>		City: <u>Michigan, ND</u>
Street Address: <u>a region N.W.</u>		<u>d Townships N.W. of City</u>
or		<u>(Enterprise, Rubin, Michigan Twp)</u>
Latitude: <u>MAP SITE #3</u>	Longitude: _____	

Priority Ranking	High <u>X</u>	Medium _____	Low _____	Undetermined _____
Project Feasibility				
Socially Acceptable	Yes <u>X</u>	No _____		
Technically Feasible	Yes <u>X</u>	No _____		
Administratively Possible	Yes <u>X</u>	No _____		
Politically Acceptable	Yes <u>X</u>	No _____		
Legal	Yes <u>X</u>	No _____		
Economically Feasible	Yes <u>X</u>	No _____		
Environmentally Acceptable	Yes <u>X</u>	No _____		

Recommended Mitigation Measure and Scope of Work: Place a sheet water level and create the acceptable level at 1504 MSL and put in a pump station system to operate annually for flood damage reduction for future years as well as the present need.

How would Project Reduce Hazard: Remove unacceptable levels of sheet water (flood water) and have a managed discharge. It will assist in protecting Nelson County Roads, one railroad track function, the City of Michigan, its homes streets, sewer and well throughout the area

Identification of Protected Species, Environmental, Historical, and/or Cultural Impact: None indicated. It appears that they thrive below anticipated water levels set by project.

Estimated Timeline: 2009-2010. yesterday is considered to late

Estimated Cost: \$1.7 million

Engineering Study Completed:	Yes <u>X</u>	No _____
Cost/Benefit Completed:	Yes <u>X</u>	No _____

Project Maintenance: Electrical operations and occasional cleaning would also be required. Minimal considering consequences

Multi Hazard Multi-jurisdiction Mitigation Project Worksheet

County: <u>Nelson</u>		
Jurisdiction: <u>Nelson County Water Resource District</u>		
Contact Name: <u>Ben Varson</u>	Contact Number: Cell <u>701 739 3900</u> <u>701 247 2682</u>	Contact Email: <u>nclwrp@polarcomm.com</u> <u>cayee@polarcomm.com</u>
Project Location: <u>NW 1/4 Sec. 22-149-58</u>		City: <u>Hoten, ND</u>
Street Address: or Latitude: <u>MAP SITE # 4</u> Longitude: _____		

Priority Ranking	High <input checked="" type="checkbox"/>	Medium <input type="checkbox"/>	Low <input type="checkbox"/>	Undetermined <input type="checkbox"/>
Project Feasibility				
Socially Acceptable	Yes <input checked="" type="checkbox"/>	No <input type="checkbox"/>		
Technically Feasible	Yes <input checked="" type="checkbox"/>	No <input type="checkbox"/>		
Administratively Possible	Yes <input checked="" type="checkbox"/>	No <input type="checkbox"/>		
Politically Acceptable	Yes <input checked="" type="checkbox"/>	No <input type="checkbox"/>		
Legal	Yes <input checked="" type="checkbox"/>	No <input type="checkbox"/>		
Economically Feasible	Yes <input checked="" type="checkbox"/>	No <input type="checkbox"/>		
Environmentally Acceptable	Yes <input checked="" type="checkbox"/>	No <input type="checkbox"/>		

Recommended Mitigation Measure and Scope of Work:
Place 18" tile in or near community and place for sheetwater flood control

How would Project Reduce Hazard: Remove Flood (Sheet Water) from townsites to protect their homes, basement and Twp. road leading into town from the east and also the railroad bed for safety to all

Identification of Protected Species, Environmental, Historical, and/or Cultural Impact:
All of those things are reviewed and protected as well as our people

Estimated Timeline:
2010-2011

Estimated Cost: \$83,000

Engineering Study Completed:	Yes <input checked="" type="checkbox"/>	No <input type="checkbox"/>
Cost/Benefit Completed:	Yes <input checked="" type="checkbox"/>	No <input type="checkbox"/>

Project Maintenance:
Tile is used to minimize maintenance but the NCLWRP will manage future cost to area

NELSON COUNTY HIGHWAY MAP NORTH DAKOTA

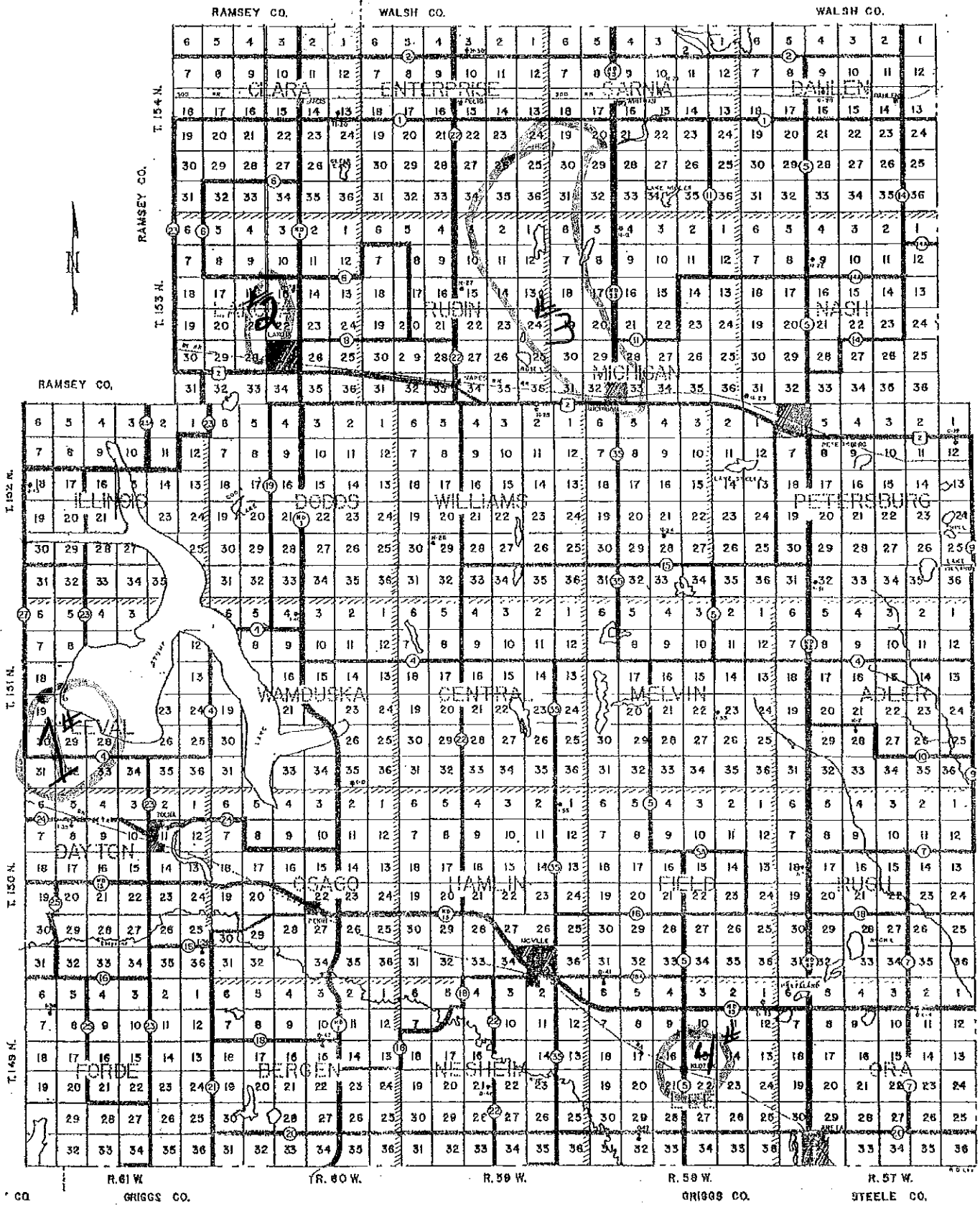

CG

R. 61 W.
GRIGGS CO.

R. 60 W.

R. 59 W.

R. 58 W.
GRIGGS CO.

R. 57 W.
STEELE CO.